

S.G.Dennahower::: Jarvis St. Fort Erie .

Mrs. dennahower was a Flake by her first marriage, lives at 316 Jarvis St. Her mother was Mrs. Hughes. her Grandmother lived in the farm house just west of Phipps St. School. She later lived in this house with her mother. The home was eventually sold and they moved into a small house on Crooks St. next to the house of Ed. Hawkin on the corner. She had two children at the time. She moved from here to Jarvis St. # 316 with her family and has lived there for 81 years.

At one time she worked in the Flat top hotel of Ed Hawkins on Jarvis, which she claims was nicknamed the "#Greezy Spoon". The home at 326 Jarvis was also bought by the Flakes and remodelled. It had been the site of Bill Hanna's Feed & Grain Store, before the turn of the Century.

rs. (Flake Dennahower also claims that the new Drake, once the Spains, was at first the VICTORIA::: 1870's .

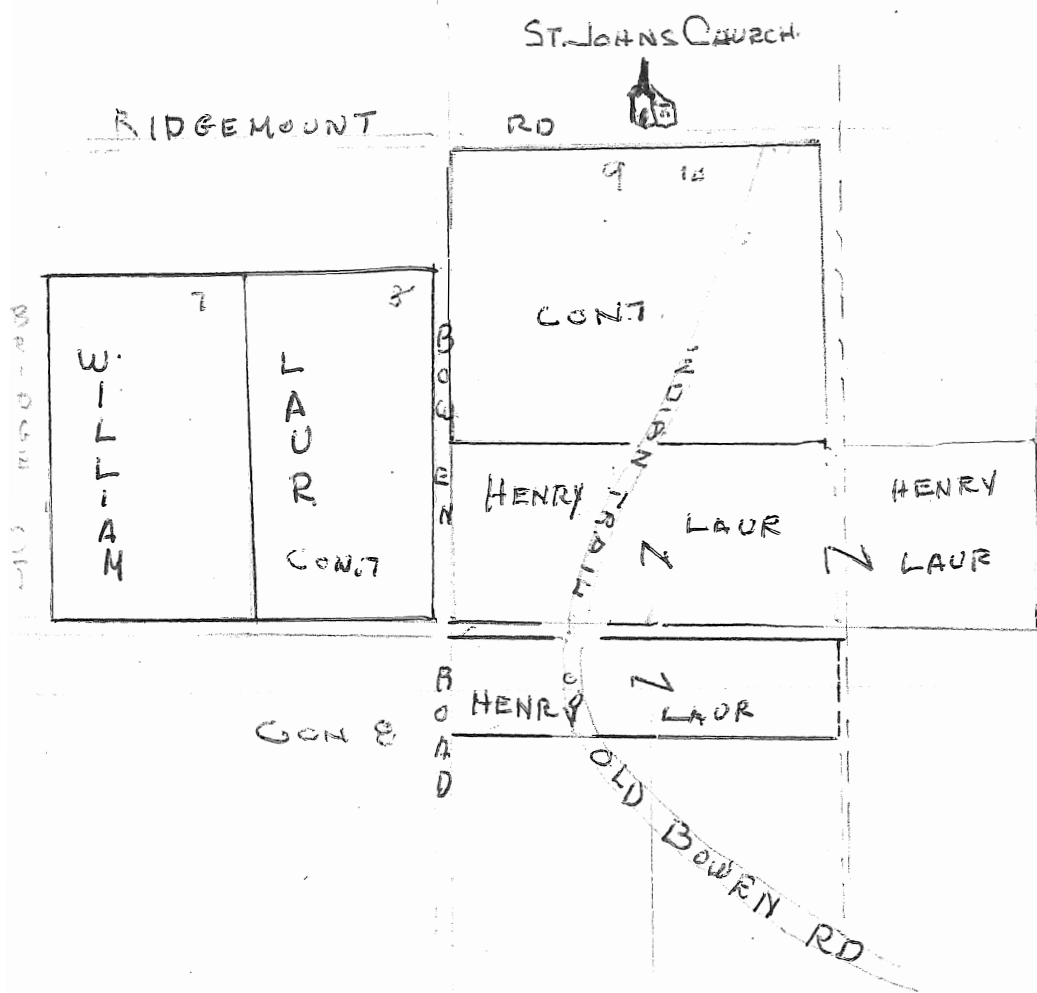
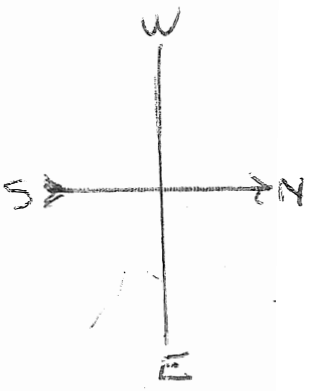

PROPERTY OF HENRY & W. LAUR.

1876 MAP OF BERTIE

LOT 9+10 PT. II CON 7.

W.M. LOT 7+8

LAUR::: from the 1851 Census:::

HENRY LAUR::: farmer 43 yrs.

Isabella 38 yrs.

Children:::

Margaret 15

(marr. Crammer Riselay Oct. 3,

Wm. H. 13

John E. 9

Elizabeth 7

James 1

Sarah Laur living with above family b. U.S.A. 83 yrs.

234

The Ontario Register

36. Cranmer Riselay, son of John & Catherine (Miller) Riselay, b. 31 May 1831, d. 14 Dec 1900 and is buried at St. Paul's, Fort Erie. He md. 5 Oct 1859 at St. Paul's Margaret Laur [TOR 1:115] who was b. 22 Sept 1837 and d. 23 Aug 1903 [dates from g. s. at St. Paul's]. She was a daughter of Henry Laur. Cranmer Riselay was for many years a Councillor of Bertie, and in 1883 he was elected Reeve, a position he was re-elected to for three succeeding years. In 1885 the Welland County Council elected him Warden of the County. [Hist. Welland County (1887) p.431]

Children of Cranmer & Margaret (Laur) Riselay:

+77. Egerton Elliott Riselay, b. 7 July 1860.

78. Margaret Hortense Riselay, never md.

79. John Cranmer Riselay, b. c.1864, "died 1 May 1882
ae 18 yrs." [g. s. at St. Paul's]

80. Isabella Catharine Riselay, b. c.1866, "died 3 Oct
1868 aged 2 yrs." [g. s., St. Paul's]

81. Jessie H. Riselay, b. 26 March 1869, d. 4 Sept 1954;
md. James Wadsworth Bond b. 14 Jan 1868, d. 21
Oct 1925 (both buried at St. Paul's; dates from g. s.)
No issue.

LAUR::::

HENRY LAUR b. 1810 d, Nov. 10, 1881.

Isabella b. 1815.d. Feb. 28, 1890.

Children of Henry & Isabella :

Margaret b.Sept. 22, 1837. d. Aug. 23, 1903.
marr: Cranmer Riselay, Oct. 1859.
b. St. Paul's Cemetery.

William H. b.
marr:
bur.

John Edwin b. 1842. d. Apr. 21, 1914.
bur. St. John's Ridgemount.

Elizabeth b.
marr:
bur:

James Edward b. ~~Nov 27~~ 1851. d.Aug. 8, 1872.
marr.
bur. St. John's Churchyard Ridgemount.