

Property deeded to Salome Miller 1836 by her father John Miller:::

Willoughby::: lot 11 in the Cross Concession : 20 acres, 3 roods and 32 perches.

Bertie Part of lot no. 16 in the 6th Concession N.R.

JOHN W. MIHLER to SALOME daughter.
EAST PT. LOT 11 CONK WILLOUGHBY
1936

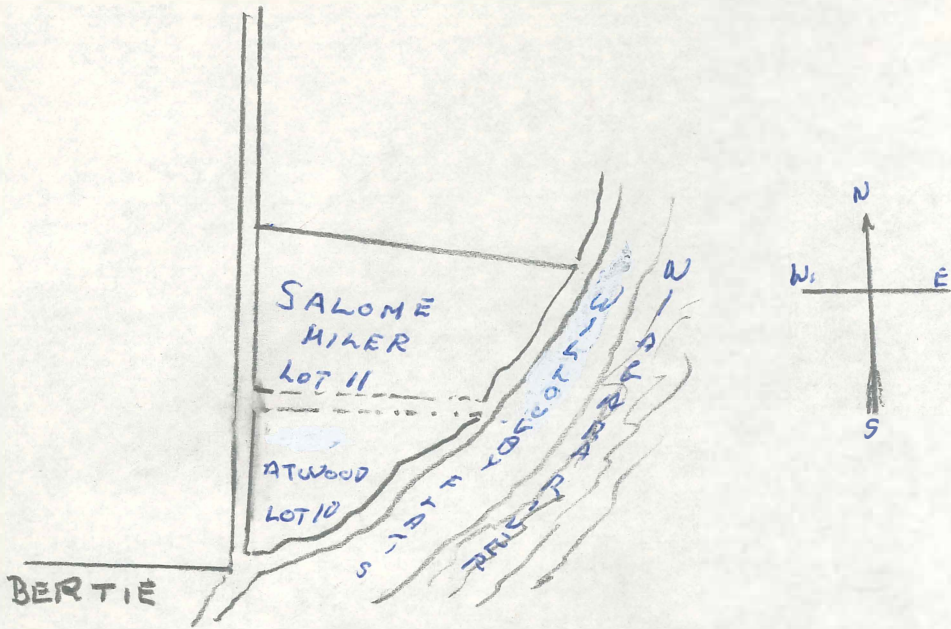

John A. Miller
son of Edward &
Salome Miller.

b. Dec. 15, 1853. d. June 14, 1884.
never marr;
bur. Mac. Afee Cemetery.

real estate at the time of death;;;

lots situated as follows::: 1. being composed of the north part
of lot # 13, in the 5 con. containing 20 acres.

2. lot:: south part of lot 14, in the 5th. con. containing $66\frac{1}{2}$ acres

3. north half of lot # 13 in the 6th. con. containing 50 acres,
also reservation for a roadway , on lot 13, in the 5th con::
all in Bertie Township and left at his death to brother Edward
Kerr Miller.

4. lot situated and being in the Township of Bertie, containing
 $1\frac{1}{2}$ acres: commencing at the north east angle of lot fifteen, in
the fifth con. of the said Township: one chain from the Niagara
River, thence west six chains more or less to a stone planted:
thence south two and a half chains : thence east six chains, to
within one chain of the Niagara River: thence north two and one
half chains to the place of the beginning.

This land left to sister Adela Salome, Miller at the time
of his death.

John A Miller was living in the red brick home with his parents
and after their death. In his will he granted a sum of \$1,200.00
to Rebecca Anquish the adopted daughter of Edward Miller and
Salome, and he granted her the right to live in the old home-
stead with free board.