

HENRY EMERICK::: FORT ERIE ONT. son of John George & Magdalena Miller.

b. Aug. 7, 1849. d. 1924.

marr. Fannie Hershey: dght. pf Salome Zavitz & John B. Hershey.

Fannie Hershey b. July 10, 1851. d. 1941.

bur. St. Paul's Cemetery, Fort Erie Ont.

Henry Emerick was born on the farm of his father John George: lots 7 & 8 in the 7th., con. Bertie::: lying on the east side of Ridgemount Rd. just south of the Bowen. He built a large two story frame home, just a short distance from the old log cabin, perhaps at the time of his marriage to Fannie Hershey in 1872. It was a two family dwelling from the start, Henry and his wife occupying one side; and possibly his mother the other, as she was deceased by that time. Unfortunately for Henry, he lost the farm shortly after. He moved to the village of Victoria (Bridgeburg) where he proceeded to build another two story frame home on the north west corner of the River Rd. and the street that was to take his name::: Emerick Ave.

Henry took up the job of Postmaster of the village, and again acquired a considerable amount of land. He did much to lay out that part of the village , running from Phipp St. to the Bowen Rd. A member of the Anglican faith, he gave the land at the cr. of Emerick and Central, N.W. for the building of St. Mary's Hall.

After the death of her husband, Fannie Emerick went to live with her neice, the daughter of Nancy Hershey a miss Fannie Wector. JohnB. Hershey and his family lived on the north side of Bertie St. just west of concession, which later became the home of the Wectors; and much later the Race Track property.

After moving to Bridgeburg Henry ran a furniture store, which was later taken over by Attwoods. He also went into the Coal Business, then into real-estate and building. As well as being postmaster of the village of Bridgeburg he was also Clerk and treasurer.

PROPERTY OF HENRY MILLER TO
JOHN B. EMERICK. 50 ACRES - N.S. Feb 7-1848
& following HENRY EMERICK 1870

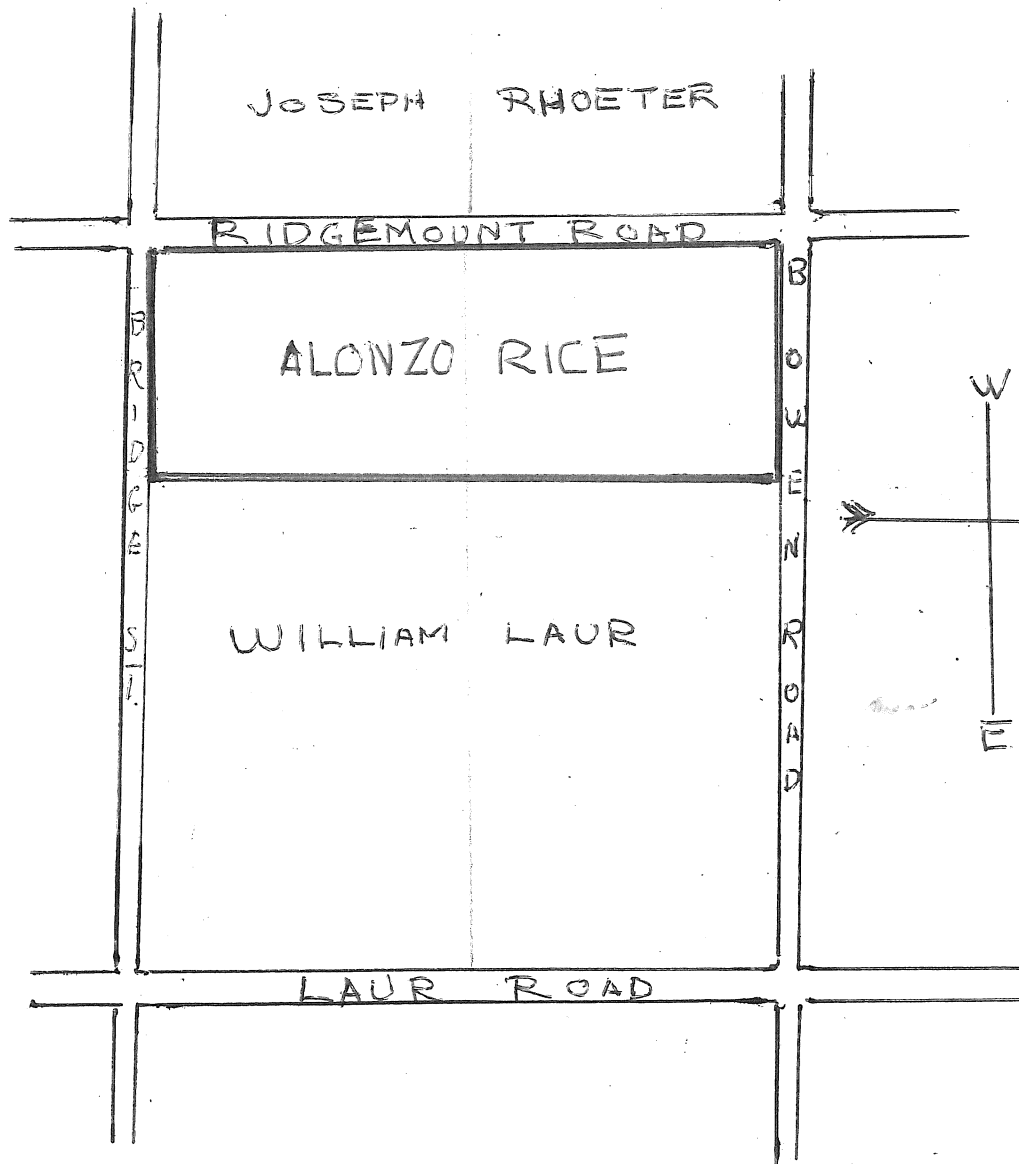

From Bentie MAP 1876.

LOT 7E 8-76 SW.

MILLER & EMERICK::: lot 7 & 8 Bertie Township.

1797 Crowm to Augustus Anchor(Anger) 100 acres.

Mar. 12.

1823. B.&.S. Augustus Anger and wife Rosanna to Hister Meyer
200 acres : lots 7. & 8 . con 7.

1836. B.&.S. Adolpnus Meyer to Dayton Holcomb: 50 acres.

1838 B.&. S. Dreyton Holcomb - Francis Summers: 50 acres

1844 B.&. S. Alphos F. Meyer to Wm. Dunn: 50 acres.
parts of lot 7 & 8 con. 7, comm. W cr.

1846 B.&. S. William by ex. to Henry Miller 100 acres.

May 4 inst.
2905.

1848 B.&. S. Henry Miller to John George Emerick: 50 acres.
Feb 7. part of 7 & 8 con. 7 . comm. W. cr.

1853 B.&. S. Wm. H. Meyer to Dayton Holcomb: 150 acres .
E. part of 7. & 8.

1869. Will West parts of 7. & 8. to his son Henry, not so long
Reg. Oct. 11 as his wife remains his widow: but to have his said
1870. son remain here upon: and furnish a comfortable
living for his said wife & daughter so long as his
said daughter reamins single and his wife remains a
widow.

1871. Herman Willson who held morgage to William Laur:
150acres: E. part of lot 7.& 8.

1874. B.&. S. Henry E. Emerick & Magdalena Emerick widow of John
Mar. 2. inst. & Fannie Emerick wife of Henry: to Barbara Rice
2072 50 acresparts of lot &. & 8. con. 7.: \$3500.

cont. lot 7. & 8. con. 7 Bertie.

etc.

1935 Grant. Ernest Miller, Orin Miller, heirs of will of
Aug. 29. Alta Miller ist part George W. Miller, Henry Miller
Luella Spear marr. Lucy Spear. marr. Alphonse Miller
& Maxime Miller wife of Orin Miller , Berelah Miller
wife of Alphonse Miller : to the said Ernest Miller
inst. # 34592.

1980 In the summer of 1980 Ernest Miller died at the old
homestead.

EMERICK::: FORT ERIE ONTARIO.

JOHN GEORGE EMERICK b. Oct. 7, 1817. d. Oct. 15, 1869.

MAGDALENA Miller wife: b. Jan. 4, 1826. d. Feb. 28, 1903.

married Dec. 29, 1846.

bur. Old mennonite cemetery Sherkston.
now: Brethren in Christ, Sherkston.

CHILDREN OF JOHN & MAGDALENA:::

ELIZABETH (Liza) b. Nov. 13, 1847. d.
marr. Abram Berry of Clarence, Erie County.

HENRY b. Aug. 7, 1849. d. 1924.
marr. Fanny Hershey.
bur. St. Paul's Cemetery Fort Erie.

LEAH b. Oct. 23, 1851. d. 1928.
marr. Edward Lee.
bur. Morgan;s Point Cemetery: Wainfleet.

ELIAS b. July 19, 1856. d. Aug. 14, 1856.
bur. Miller cemetery Willoughby.

After the death of her husband Magdalena Emerick married Peter Sherk.
(1814- 1889)

3. MARGARET HERSHEY:

b. 1811. d. 1874.

daughter of Abraham (1770 1856) & Margaret
marr. oct. 26th. 1837 to Edward Lee(1811/1887.
lived in Marshville.
burr. Morgan's Point Cemetery.

Children of Margaret & Edward Lee:

Edward 1854- 1931 .
marr. Leah Emerick(1851-1928)

Dod

Martha A. 1849. 1851 .

infant daughter: b. Apr. 8. 1838
7 mon. 19 dys. burr. Mc.Affee.

margaret 1840. 1917.
burr.
marr. A.W. Haun .(1836-1873)

ELIZABETH EMERICK

b. Nov. 13, 1847. d.

marr. 1869 to Abram Berry:son of Elizabeth
& John Berry.

moved to Clarence where her children were born.

Children of Elizabeth Emerick & Abram Berry:::

VICTOR EMANUEL b. Sept. 22, 1869.

George Emerick b. Feb. 1, 1871. d. May 22, 1871.

Annia Erminia b. Mar. 30, 1872. d.

Arthur Herbert b. May 24, 1874. d. Sept. 18, 1877.

Richard Grant b. June 4, 1877. d. Apr. 13, 1895.

Alvin Henry b. Aug. 12, 1879. d.

Howard Bergtold b. Dec. 1. 1881. d.

Clarence Clement b. 4. 1884. d.

Magdalena Emily b. July 28, 1886. d.

Alice Maria b. May 28, 1890. d. Aug. 18. 1891.

Leah Helen b. Aug. 29, 1892. d.

HENRY EMERICK::: b. Aug. 7, 1849. d. 1924.

marr. Fannie Hershey : dght. of Salome Zavitz
& John B. Hershey. (Fannie : b. July 10. 1851)
bur. St. Pal's Cemetery. Fort Erie.
no issue.

LEAH EMERICK b. Oct. 23, 1851. d. 1928.

marr. Edward Lee: Aug. 1. 1877. (b. 1854. d. 1931.)
bur. Morgan's Point Cemetery: Wainfleet.

children of Leah Emerick & Edward Lee:::

Harold b. July 23, 1878. d.

Arthur Warren b. Feb. 21, 1880. d. 1964.

Leah Ethel b. Jan. 18, 1882. d.

Edward b. Jan. 13, 1885. d.

MAGDALENA b. Oct. 2, 1888. d. Oct. 22, 1888.

Lee::::

12 Emerick Ave.

b. Feb. 21, 1880. d. 1964.
bur. St. Paul's Cemetery Fort Erie.

Warren Lee of # 12 Emerick Ave. & his wife Mary Witmer lived for the first few years of their marriage, with Henry Emerick and his wife on the river road. They built their own home thurther west on the north side of Emerick in 1911.

Warren got a job with the pst office, of which Mr. Emerick was Postmaster, then he aquired a job with the Canadian Custom's Staff. He remained in this position for thirty-five years, travelling on the trains, that operated between Buffalo, Fort Erie and Toronto.

Mr. Lee's grandparents were Edward Lee, and Margaret Hershey. They lived in Marshville Ont., where they owned a general store, a grist mill, and a good bit of the land on which the town was built.

Warren's wife came from a large family of thirteen children from Williamsville N.Y. her father being Christian Witmer .

Warren Lee of Lowbanks , was married in Williamsville N.Y. Sept. 27, 1905 to Mary Witmer: dght. of Mary Cotton & Christian Witmer of Williamsville N.Y.

STEVENS:::

JOSEPH STEVENS b. 1833. d. July 27. 1887. 46yrs.
buried in Ridgeway Cemetery Garrison Rd.

Although not marked his wife is buried next grave.
also Frank Stevens is buried here.

George Stephens son of Joseph & Margaret Stephens
b. 1861 d. July 27th . 1887 : 26yrs.

they had four childre; Howard: George Frank Dolly: murre

Joseph Stevens operated a Hotel on the river road in the 1860's
by the foot of Ferry St. (Boweb Rd.) It is said by his grand-
daughter that at one time he also owned the dock and the shingle
mill. During the Fenian Raids O' Neil spared the hotel and the
shingle mill. Mr. Stevens became ill however and moved to a farm
on Gilmore Rd. He did not remain there long for the Stevens had
a story and a half frame home built on the south side of Gilmore,
and what later became Kingsmill , in 1869. It was the only home
on that side of the street from concession to the river.

