

JEROME JANSEN:::

Jerome Jansen carpenter, built this large two story frame home before his marriage to Florence Paulus who lived next door with her family. After their marriage the young couple moved in. Several years later they sold to Ed, Burger , and they rented for a time. At the time of the construction of the Peace Bridge the home was owned by Mary Soltzman. It was purchased by the Peace Bridge Comp., sold and moved to it's present spot on the north side of Princes, four doors from the corner of Archange.

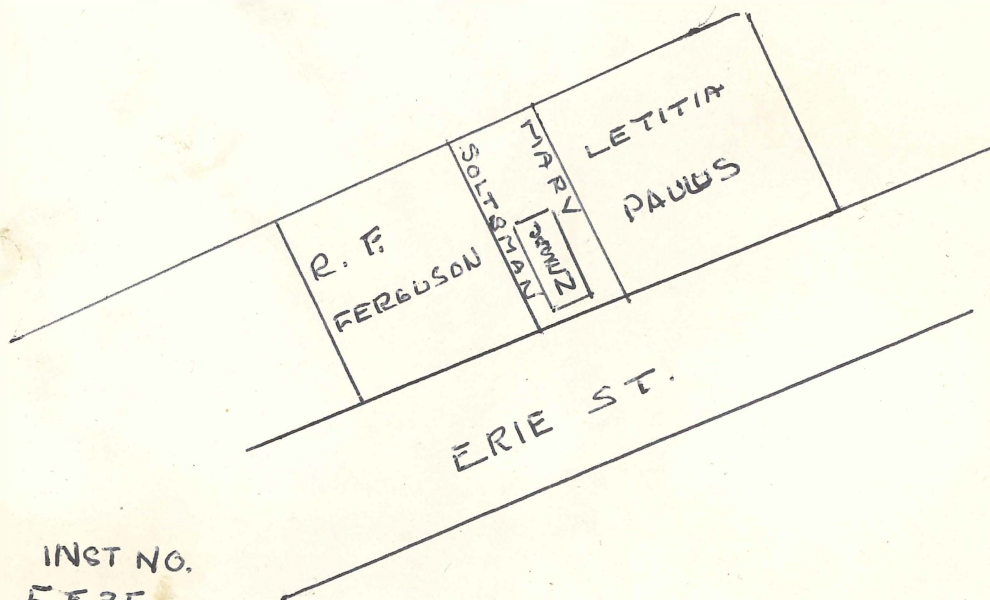

INST NO.  
5535